

3041 Trenwest Drive

WINSTON-SALEM, NC 27103

MEDICAL/OFFICE SPACE

FOR LEASE



±3,416 SF medical/office space available. Great curb appeal and visibility from both Trenwest Drive and Stratford Road. Conveniently located between Bethesda Road and Forsyth Medical Center. The property is well-suited for a single-tenant medical or office user with ample parking available.

LEARN MORE ABOUT THIS PROPERTY



Jeff Jordan

E Jeff@LTPcommercial.com

M 336.689.4172

P 336.724.1715

L | T

3041 Trenwest Drive

WINSTON-SALEM, NC 27103

MEDIAL/OFFICE SPACE

FOR LEASE



TO LEARN MORE ABOUT THIS PROPERTY, CONTACT:

Jeff Jordan

Jeff@LTPcommercial.com

3041 Trenwest Drive

WINSTON-SALEM, NC 27103

MEDICAL/OFFICE SPACE

FOR LEASE

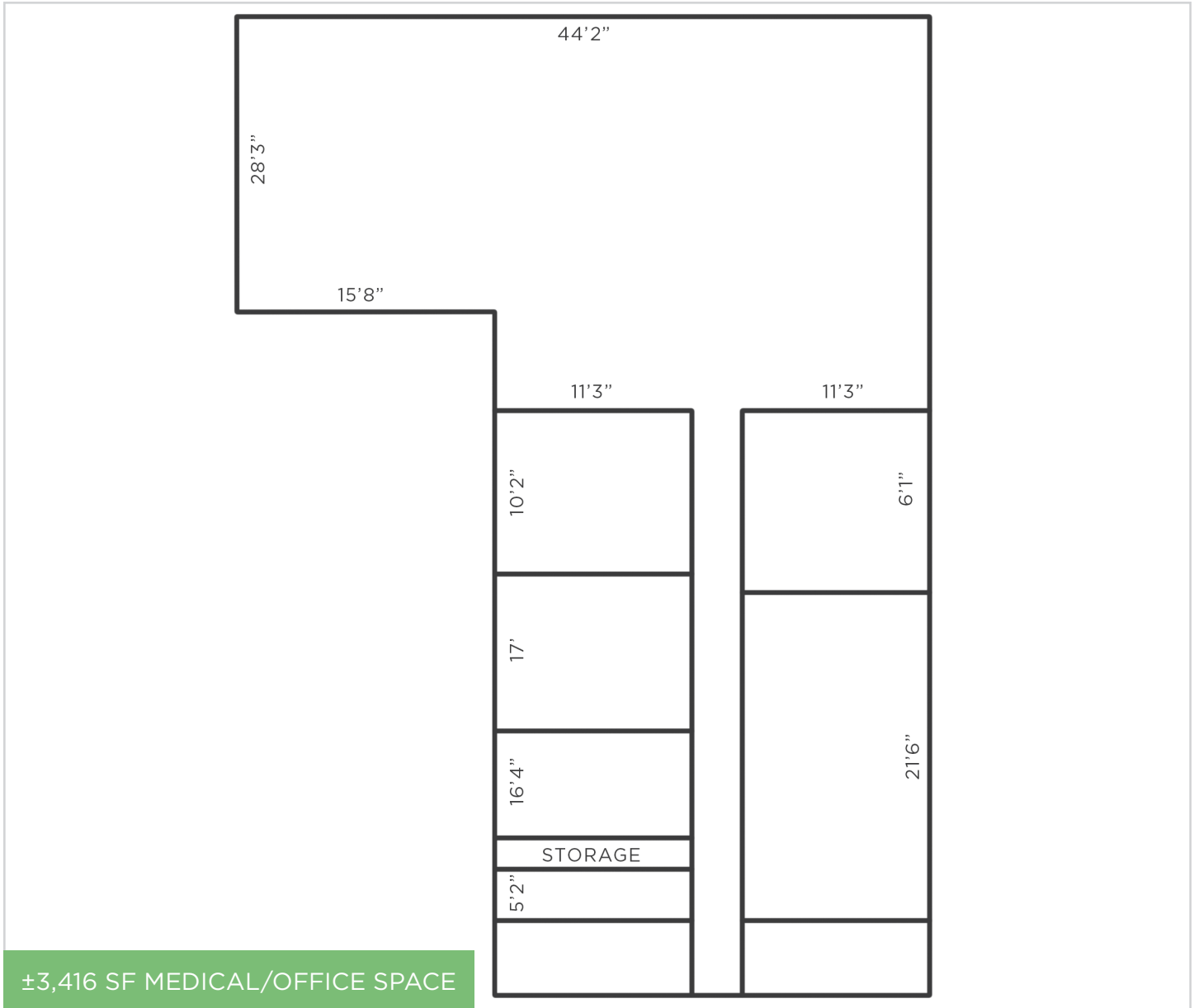

TO LEARN MORE ABOUT THIS PROPERTY, CONTACT:

Jeff Jordan

Jeff@LTPcommercial.com

3041 Trenwest Drive

WINSTON-SALEM, NC 27103

MEDIAL/OFFICE SPACE

FOR LEASE



LOCATION

Address 3041 Trenwest Drive, Winston-Salem NC 27103

PROPERTY DETAILS

Property Type	Office	Available SF ±	3,416	Year Built	1970
Acres ±	0.28	Building SF ±	3,416	Year Renovated	1982

TAX INFORMATION

Zoning	HB	Tax PIN	6815-61-8097
---------------	----	----------------	--------------

LEASE INFORMATION

Lease Rate	\$13.75	Lease Type	Modified Gross
-------------------	---------	-------------------	----------------

Description ±3,416 SF medical/office space available. Great curb appeal and visibility from both Trenwest Drive and Stratford Road. Conveniently located between Bethesda Road and Forsyth Medical Center. The property is well-suited for a single-tenant medical or office user with ample parking available.

The information contained herein has been taken from sources deemed to be reliable. Linville Team Partners makes no representation or warranties, expressed or implied, as to the accuracy of this information. All information in this document is subject to verification prior to purchase or lease.

TO LEARN MORE ABOUT THIS PROPERTY, CONTACT:

Jeff Jordan
Jeff@LTPcommercial.com