

556 ARBOR HILL ROAD

FOR LEASE | KERNERSVILLE, NC 27284

Linville | Team Partners

COMMERCIAL REAL ESTATE



PROPERTY HIGHLIGHTS

PROPERTY TYPE	Office/Flex
SUITE A	2,338 SF
SUITE J	3,696 SF
LEASE RATE	\$12.00 psf, Modified Gross

DESCRIPTION

Great office/flex space available in Kernersville! Suites range from \pm 2,338-3,696 SF. Each suite features a private entrance, restroom, flexible layouts, and rear roll-up doors or double pedestrian doors (no dock height doors). Located off of S. Main Street and US-421/Salem Parkway, close to many restaurants and retailers.

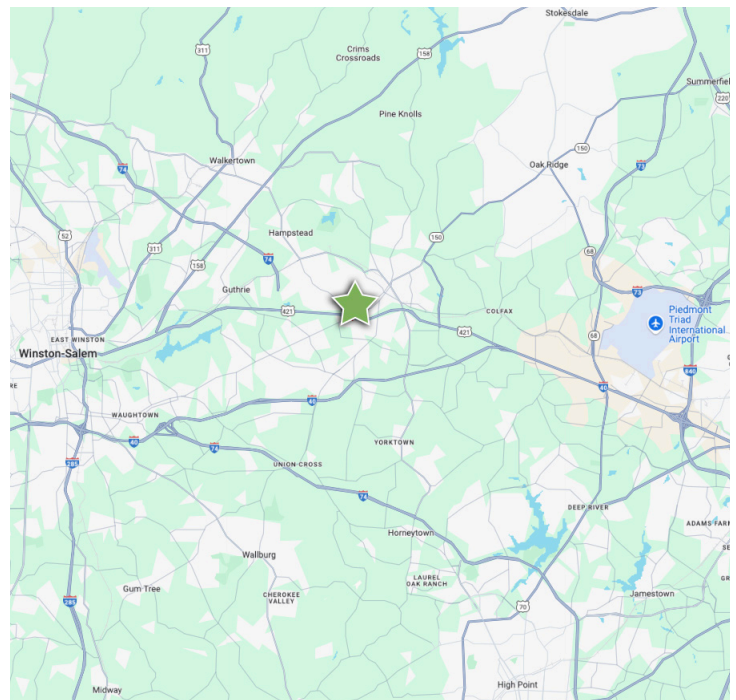

KATIE HAYES

E Katie@LTPcommercial.com

M 336.473.0206

P 336.724.1715

NICK GONZALEZ

E Nick@LTPcommercial.com

P 336.724.1715

556 ARBOR HILL ROAD

FOR LEASE | KERNERSVILLE, NC 27284

Linville | Team Partners

COMMERCIAL REAL ESTATE



L | T

206 W. FOURTH STREET • WINSTON-SALEM • NORTH CAROLINA • 27101

LTPCOMMERCIAL.COM • 336.724.1715

556 ARBOR HILL ROAD

FOR LEASE | KERNERSVILLE, NC 27284

Linville | Team Partners

COMMERCIAL REAL ESTATE

FLOOR PLAN

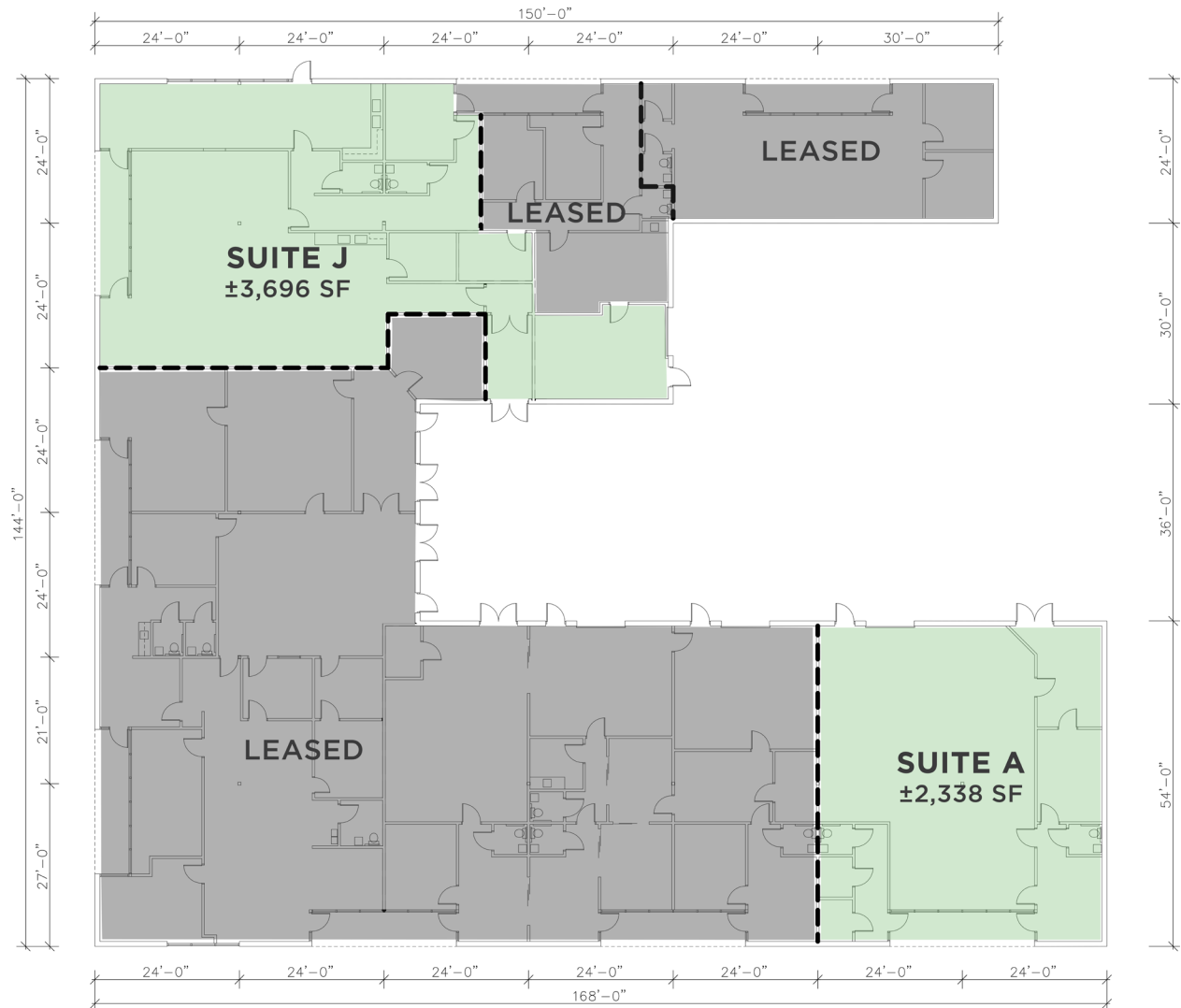

L | T

206 W. FOURTH STREET • WINSTON-SALEM • NORTH CAROLINA • 27101

LTPCOMMERCIAL.COM • 336.724.1715

556 ARBOR HILL ROAD

FOR LEASE | KERNERSVILLE, NC 27284

Linville | Team Partners

COMMERCIAL REAL ESTATE



PROPERTY INFORMATION

PROPERTY TYPE	Office/Flex	BUILDING SIZE ±	16,512 SF
AVAILABLE SF ±	2,338 - 3,696	PARKING	Surface
ACRES	1.61	TAX PIN	6876-70-8304
YEAR BUILT/RENOVATED	1988/2008	ZONING	HB

PRICING & TERMS

SUITE A	2,338 SF	LEASE RATE	\$12.00 psf
SUITE J	3,696 SF	LEASE TYPE	Modified Gross

DESCRIPTION

Great office/flex space available in Kernersville! Suites range from ±2,338-3,696 SF. Each suite features a private entrance, restroom, flexible layouts, and rear roll-up doors or double pedestrian doors (no dock height doors). Located off of S. Main Street and US-421/Salem Parkway, close to many restaurants and retailers.

The information contained herein has been taken from sources deemed to be reliable. Linville Team Partners makes no representation or warranties, expressed or implied, as to the accuracy of this information. All information in this document is subject to verification prior to purchase or lease.